



nswproperties

BRIDGE AVENUE, ORMSKIRK, LANCASHIRE, L39.

ASKING PRICE: £725 PCM

Bridge Avenue, Ormskirk, Lancashire, L39

****FIRST MONTHS RENT HALF PRICE, IF YOU MOVE IN DECEMBER****

NSW Properties are delighted to bring to the rental market this end terraced property within easy reach of Ormskirk town center and its associated amenities. This property can be offered as fully furnished or unfurnished.

This lovely home briefly comprises entrance hallway leading through to the lounge with front aspect. There is a feature gas fireplace with marble back and cast iron surround. Through from the lounge is a large modern fitted kitchen/diner with velux window and French doors that look out onto the garden. There is a range of modern fitted units, stainless steel sink with drainer. There is an integrated oven, hob, grill and microwave. There is also a handy under stairs storage cupboard. To the rear of the property is a modern family bathroom.

To the first floor there are 3 bedrooms with the master having a shower room. Externally there is a small cobbled front garden with mature shrubs. The rear garden has a part decked seating area and well maintained laid to lawn garden with mature shrubs.

Further benefits also include gas central heating and double glazing. Two car parking space's are also available with permit's, estimating about £35 per year.

Available: December 2016

Bedrooms: 3

Deposit: £725

No Pets



Ground Floor

Approx. 43.7 sq. metres (470.0 sq. feet)

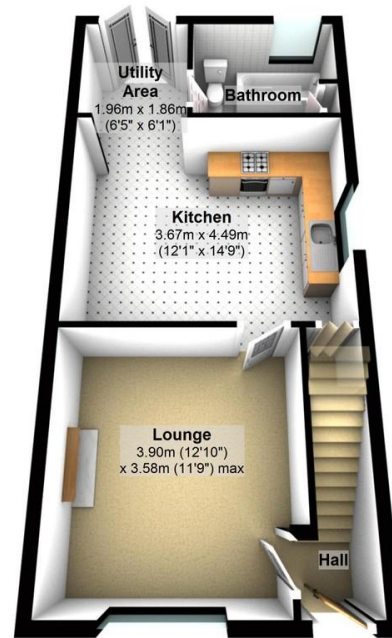

Total area: approx. 78.1 sq. metres (840.5 sq. feet)

Energy Efficiency Rating

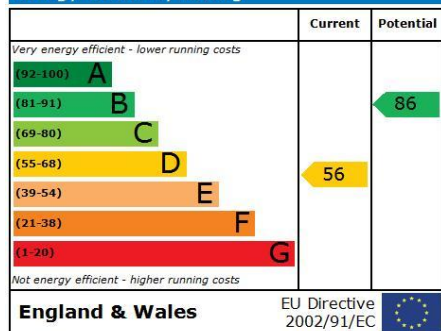

Environmental (CO₂) Impact Rating

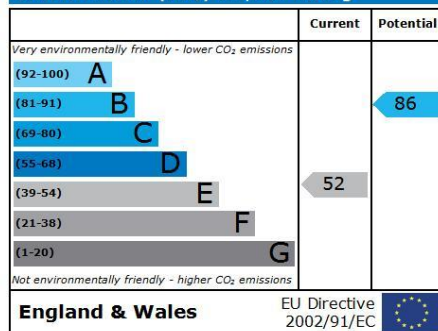

A: NSW PROPERTIES LTD | 19 CHURCH STREET ORMSKIRK | L39 3AE
 T: 01695 581260
 E: INFO@NSWPROPERTIES.CO.UK
 W: NSWPROPERTIES.CO.UK

Disclaimer

These particulars, whilst believed to be accurate are set out as a general outline only for guidance and do not constitute any part of an offer or contract. Intending purchasers should not rely on them as statements of representation of fact, but must satisfy themselves by inspection or otherwise as to their accuracy.

